

Soils Map

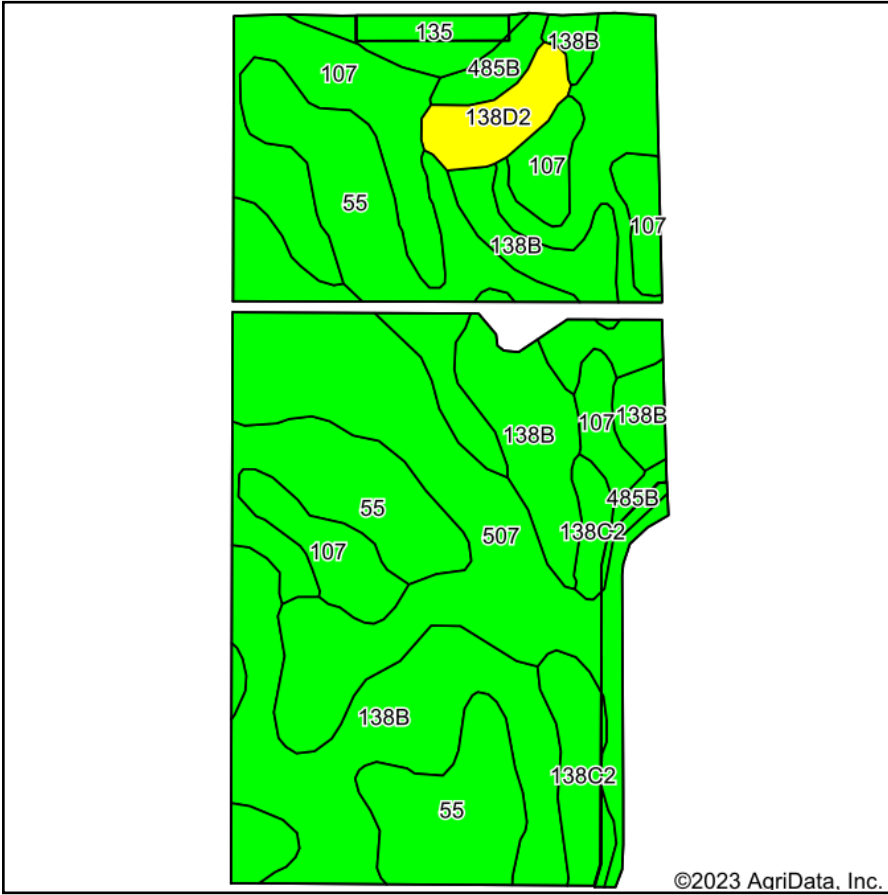

©2023 AgriData, Inc.

Soils data provided by USDA and NRCS.

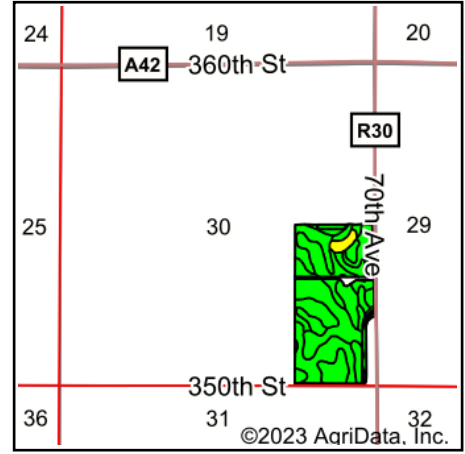

State: **Iowa**
 County: **Winnebago**
 Location: **30-98N-25W**
 Township: **Linden**
 Acres: **72.88**
 Date: **11/6/2023**



Maps Provided By:



© AgriData, Inc. 2023

www.AgriDataInc.com



Area Symbol: IA189, Soil Area Version: 33

Code	Soil Description	Acres	Percent of field	CSR2 Legend	Non-Irr Class *c	CSR2**	CSR	
55	Nicollet clay loam, 1 to 3 percent slopes	20.66	28.3%		Iw	89	88	
138B	Clarion loam, 2 to 6 percent slopes	17.03	23.4%		Ile	89	80	
507	Canisteo clay loam, 0 to 2 percent slopes	16.11	22.1%		IIw	84	78	
107	Webster clay loam, 0 to 2 percent slopes	10.81	14.8%		IIw	86	83	
138C2	Clarion loam, 6 to 10 percent slopes, moderately eroded	3.19	4.4%		IIIe	83	63	
138D2	Clarion loam, 9 to 14 percent slopes, moderately eroded	1.92	2.6%		IIIe	51	54	
135	Coland clay loam, 0 to 2 percent slopes, occasionally flooded	1.74	2.4%		IIw	76	78	
485B	Spillville loam, 2 to 5 percent slopes	1.42	1.9%		Ile	88	85	
Weighted Average						1.79	85.9	80.9

**IA has updated the CSR values for each county to CSR2.

*c: Using Capabilities Class Dominant Condition Aggregation Method
 Soils data provided by USDA and NRCS.